

This drawing is property of Cox Geelen and may not be copied in whole or in part without the prior written consent of the owner

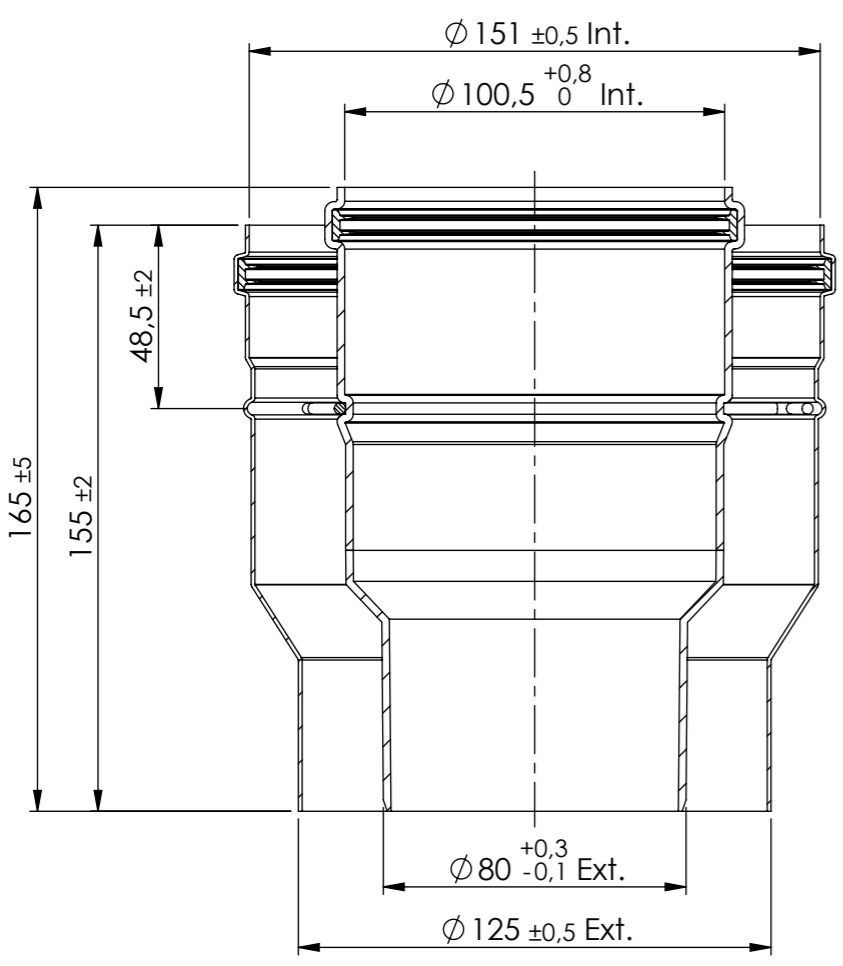

SECTION A-A

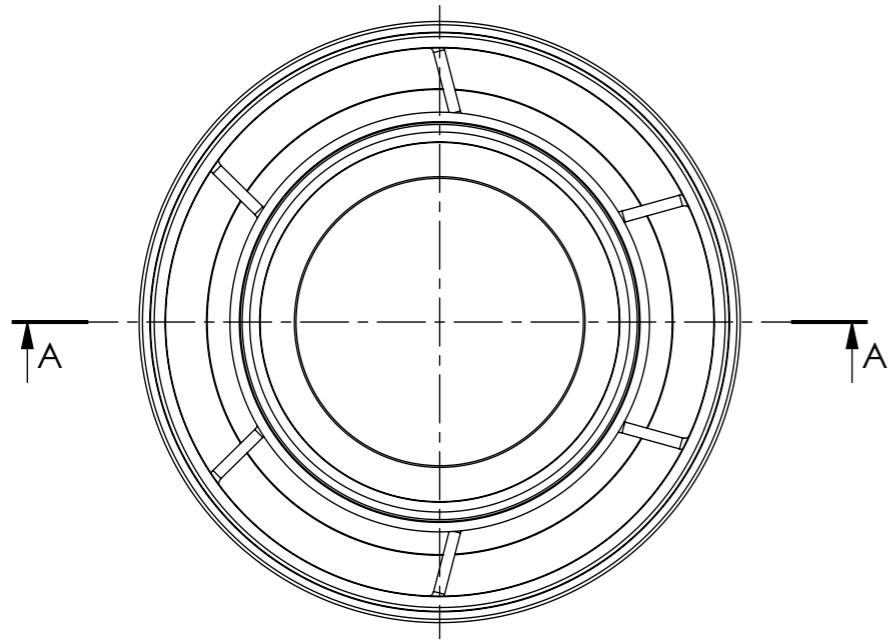
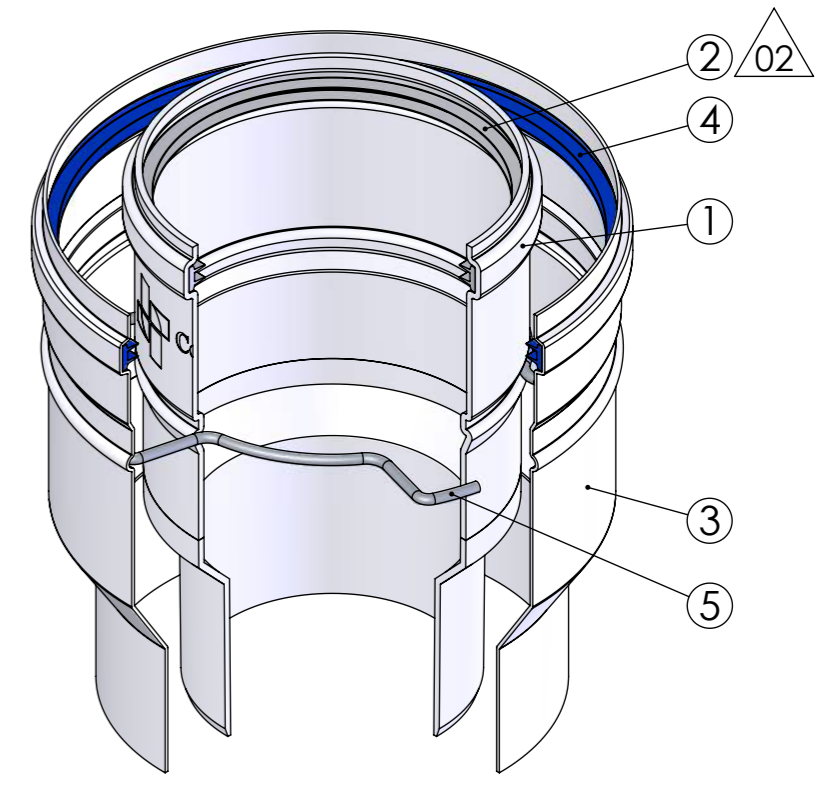

Pos.	QTY.	Description	Material	Drawing	Part nr
5	1	Spring	AISI 301	A2263	891123
4	1	Seal VMQ Air ø150	VMQ Air	A2641	700363
3	1	Expansion ø125/150	EN-AW-1050A	A2435	-
2	1	Seal EPDM Flue gas ø100 S	EPDM Flue gas	A1960	891311
1	1	Expansion ø80-100 Centric	CoxPP	A2440	710089

Scale: 1:2 Unit of measure: mm Material: CoxPP - Al Comments: Thickness of coating: average ≥70µm

Title: Adapter ø80/125-ø100/150

CAD Model: Adapter D80-125 D100-150 PP-Al Configuration: Section

Revisions	Created	Checked
02 Seal colour flue pipe changed	17006 21-12-2017 M. Ubags	E. Franssen
01 Tolerance changed	13020 30-05-2016 F. Knoops	C. Vaessen
00 Production drawing	13020 27-01-2014 M. Ubags	C. Vaessen

Tolerances:
 $\phi = \pm 0,5$
 $L = \pm 3$
 $\angle = \pm 3^\circ$

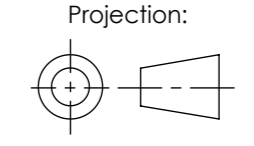

Dwg. no. : **A2431 P02** A3