

This drawing is property of Cox Geelen and may not be copied in whole or in part without the prior written consent of the owner

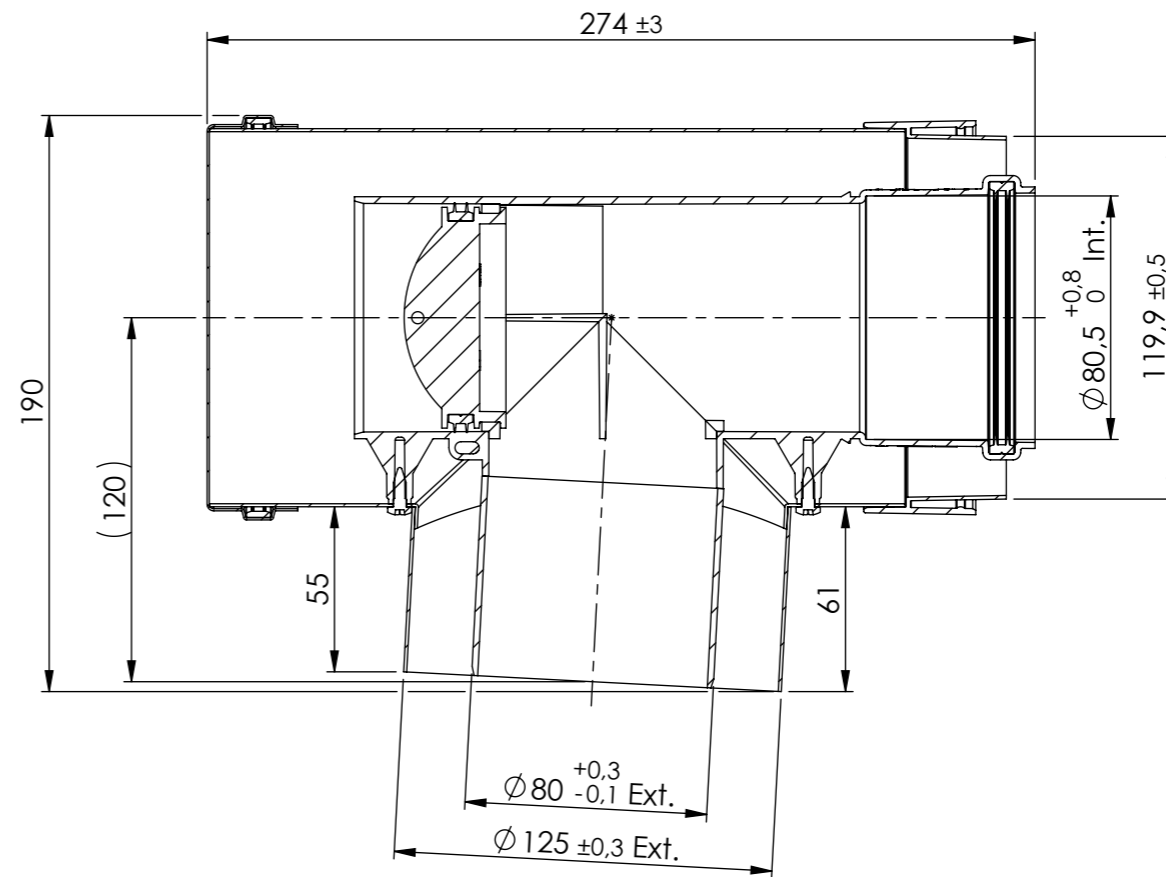

SECTION A-A

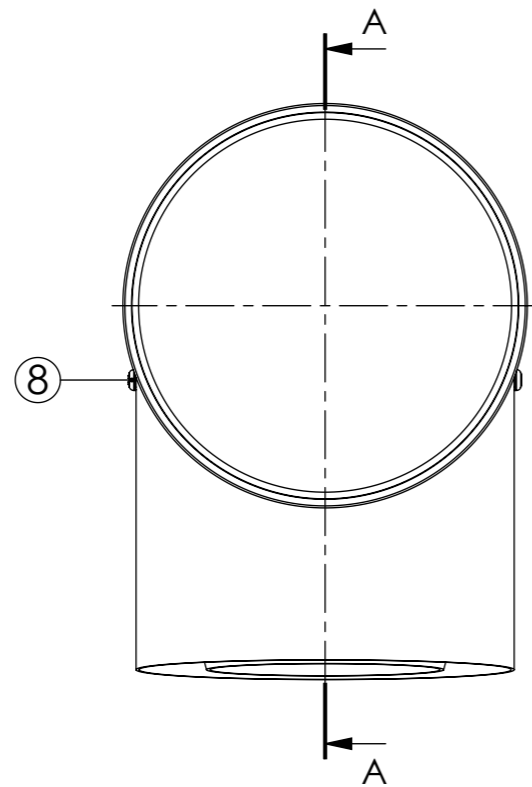
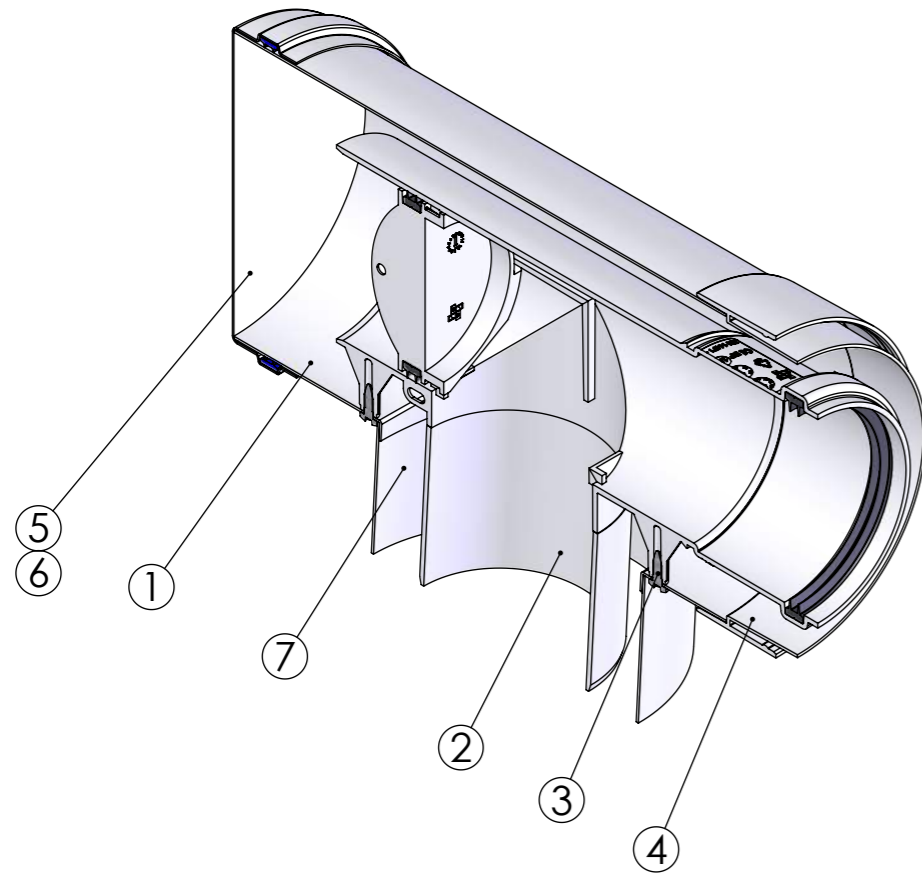

Pos.	QTY.	Description	Material	Drawing	Part nr
8	2	Self-tapping torx screw 3.9 x 13	Galvanized	-	890043
7	1	Air pipe ø125	EN-AW-1050A	A3990	710003
6	1	Seal VMQ Air ø125	VMQ Air	A2641	700249
5	1	Cap	EN-AW-1050A	07279	860642
4	1	Coupling unit ø125	PC/ABS	A3983	891544
3	2	Screw 4.2 x 13	Galvanized	-	890042
2	1	Inspection T-piece ø80 PP	-	-	-
1	1	Air pipe T-piece ø125 Connext	EN-AW-1050A	B0060	

Scale: 1:2.5    Unit of measure: mm    Material: CoxPP - Al

Title: Inspection T-Piece ø80-125 Connext

CAD Model: Inspectie T-piece 80-125 PP-Al coupling  
Configuration: Standard



Tolerances:  
 $\varnothing = \pm 0,5$   
 $L = \pm 3$   
 $\angle = \pm 3^\circ$

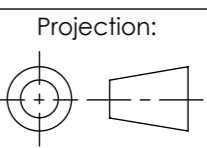

Comments:  
Thickness of coating: >70µm

00	Production drawing	13020	23-05-2016	F. Knoop	C. Vaessen
	Revisions			Created	Checked

Dwg. no. : **B0059 P00** A3